

Sold

56 Candlebark Dr, Shepparton North

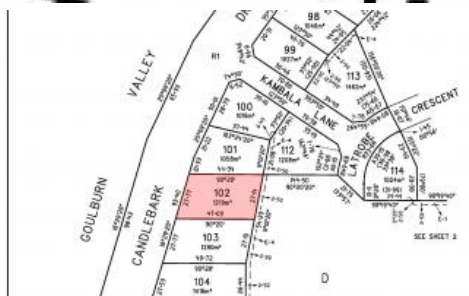

Large 1,219m² Residential Block in the Popular Grammar Park Gardens Estate

Fully constructed, title released and ready to build on now!

One of the most affordable in the whole Estate as the latest releases in Stage7 are selling from \$195,000+

Grammar Park Gardens has now become one of the most exclusive Estates in the Goulburn Valley!

Call Glenn Young for full details.

The above information provided has been furnished to us by the vendor/s. We have not verified whether or not that information is accurate and do not have any belief in one way or the other in its accuracy. We do not accept any responsibility to any person for its accuracy and do no more than pass it on. All interested parties should make and rely upon their own inquiries in order to determine whether or not this information is in fact accurate.

1,219 m²

Price SOLD for
\$172,000

Property Type Residential

Property ID 3158

Land Area 1,219 m²

Agent Details

Bree Graham – 0437 312
221

Office Details

Shepparton
123 Wyndham St
Shepparton VIC 3630
Australia
03 5820 8777

