

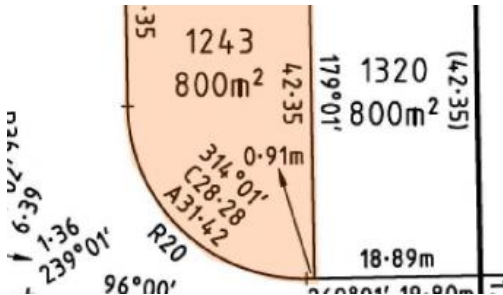

Lot 1243 Malmsbury Crescent, Kialla



Kialla Lakes Estate

The premier land development in the Goulburn Valley. With 3 lakes, connecting shared walking paths and extensive reserve and open areas it's no wonder that Kialla Lakes is "the place to be".

Call in and see for yourself the new Display Homes (plus those under construction) overlooking the huge "Falcon Park" and the newest school to the Shepparton region – St. Annes Catholic School well under construction.

For full details please do not hesitate to contact our office

The above information provided has been furnished to us by the vendor/s. We have not verified whether or not that information is accurate and do not have any belief in one way or the other in its accuracy. We do not accept any responsibility to any person for its accuracy and do no more than pass it on. All interested parties should make and rely upon their own inquiries in order to determine whether or not this information is in fact accurate.

800 m2

Price SOLD for
\$130,000

Property Type Residential

Property ID 2069

Land Area 800 m2

Agent Details

Glenn Young – 0438 579
993

Bree Graham – 0437 312
221

Office Details

Shepparton
123 Wyndham St
Shepparton VIC 3630

Australia

03 5820 8777

